



Snap In Flexible  
Connector



*Distributed by*

**POWDER-SOLUTIONS**  
1620 Lake Drive W, Chanhassen, MN 55317  
Tel: 877-236-3539 Fax: 952-279-5206  
[www.powder-solutions.com](http://www.powder-solutions.com)

# FROM THIS....



**UNSANITARY**



**DIFFICULT TO FIT**



**PRODUCT BUILD UP ISSUES**

	Standard Hose Clamped Flexible Connectors	BFM® System
<b>SANITATION</b>	Product build up between the flexible connector and the side wall of the spigot.	No crevices for product to get caught in.
<b>SIZING</b>	From inaccuracies in measuring on site through to production, it can be very difficult to get a perfect fit of a hose clamped connector.	<b>PERFECT</b> fit every time.
<b>FITTING</b>	Both the speed and accuracy of fitting hose clamps can vary widely and often clamps are not fitted correctly.	Can only fit in exactly the correct place, i.e. in or out.
<b>EXPLOSION</b>	In an over pressure situation, hose clamps are normally the weakest link and give up or let go long before the flexible connector would be due to rupture.	Only seals tighter under high pressures.
<b>STANDARD SIZES</b>	Current flexible connectors are made any size whatsoever, hence there are thousands of different sizes.	Set standard sizes in 50mm increments helps standardise stock holdings of spare parts.
<b>HEALTH &amp; SAFETY</b>	When using screw drivers to tighten hose clamps, damage is common to the flexible connector and even to the installers hands.	Tool free connector changing, simply snap in with your hands.

# TO THIS....



**SANITARY**



**EASY TO FIT**



**ELIMINATES PRODUCT BUILD UP**



**BFM® Specifications**



POWDER-SOLUTIONS  
Tel: 877-BFM-FLEX Fax: 952-279-5206  
www.powder-solutions.com



# BFM® SPIGOTS

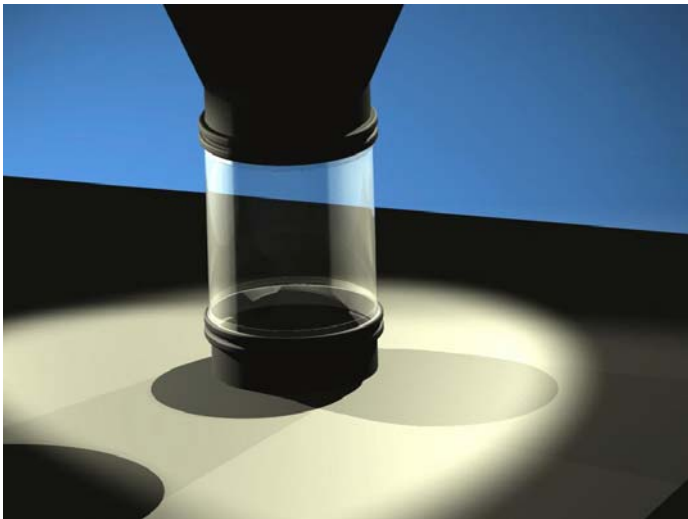

When welding the BFM® Fittings to your equipment the Application Length must be accurately measured.

Ø (Diameter)
4" / 100mm
6" / 150 mm
8" / 200mm
10" / 250mm
12" / 300mm
14" / 350mm
16" / 400mm
18" / 450mm
20" / 500mm
22" / 550mm
24" / 600mm
26" / 650mm

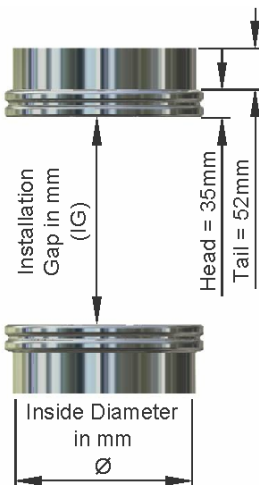

**In-line static equipment**  
IG = CL – 10mm

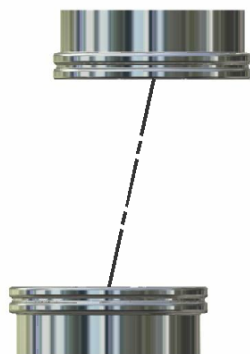

**Off Set equipment**  
IG = CL – 20mm

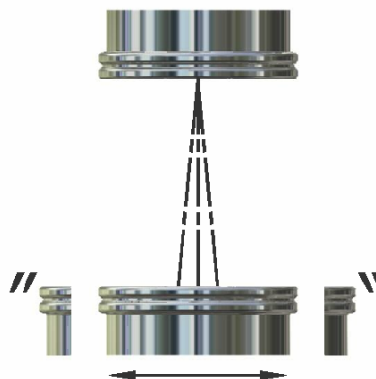

**Oscillating equipment**  
IG = CL – 40mm

CL = Connector Length (See BFM® Flexible Connector Sheet)

- Note:
1. The stainless steel spigots (flanges) have a tail 52mm (2") long. These can be easily cut down or cut on an angle to suit your existing pipe work; see installation instructions for more information.
  2. It is important to weld the spigots onto your pipe work with the length of the flexible connector in mind. Standard length flexible connectors will be stocked and hence will be more readily available, and less expensive than non standard lengths.
  3. For applications where there is a possibility for static build up, e.g. wood dust, flour, milk powder etc., we recommend using a static dissipative wire (strip), connecting the two BFM® Spigots together.



# BFM® Specifications

# BFM<sup>®</sup> FLEXIBLE CONNECTOR



Illustrated BFM<sup>®</sup> Connector  
manufactured using 040 Seeflex  
material (Clear Urethane)



Ø (Diameter)	Standard Length (CL)
4" / 100mm	6" / 150mm
6" / 150 mm	6" / 150mm
8" / 200mm	8" / 200mm
10" / 250mm	8" / 200mm
12" / 300mm	8" / 200mm
14" / 350mm	8" / 200mm
16" / 400mm	8" / 200mm
18" / 450mm	8" / 200mm
20" / 500mm	8" / 200mm
22" / 550mm	8" / 200mm
24" / 600mm	8" / 200mm
26" / 650mm	8" / 200mm

Read this sheet in conjunction with the BFM<sup>®</sup> Spigots page

Contact **877-BFM-FLEX** for full range of materials available

*Distributed by*



**POWDER-SOLUTIONS**  
1620 Lake Drive W, Chanhassen, MN 55317  
Tel: 877-BFM-FLEX Fax: 952-279-5206  
www.powder-solutions.com



**BFM<sup>®</sup> Specifications**